

Parcela (1Dr) Strada Mărășești

Nr. Pct.	Coordonate pct.de contur		Lungimi laturi D(i,i+1)
	Y [m]	X [m]	
1	602520.686	314154.638	3.382
2	602520.017	314157.953	18.614
3	602519.877	314176.566	1.011
4	602520.876	314176.720	0.082
5	602520.955	314176.742	18.093
6	602520.286	314194.823	25.810
7	602517.098	314220.435	17.092
8	602511.506	314236.586	28.028
9	602502.336	314263.071	12.502
10	602495.878	314273.776	12.073
11	602490.420	314284.545	6.778
12	602486.661	314290.185	3.831
13	602484.158	314293.085	3.561
14	602481.006	314291.429	24.587
15	602467.991	314312.289	31.287
16	602450.435	314338.186	9.957
17	602444.819	314346.408	25.387
18	602430.007	314367.026	4.543
19	602427.100	314370.517	15.015
20	602416.252	314380.899	11.726
21	602410.868	314391.316	3.275
22	602409.405	314394.246	10.211
23	602404.897	314403.408	10.159
24	602400.061	314412.342	6.357
25	602395.733	314416.998	6.319
26	602391.565	314421.748	4.310
27	602387.908	314424.028	4.349
28	602383.813	314425.493	5.266
29	602378.681	314426.672	17.498
30	602362.393	314420.278	8.527
31	602359.978	314428.456	22.024
32	602377.574	314441.702	5.354
33	602380.117	314436.991	4.189
34	602382.172	314433.341	2.818
35	602384.523	314431.788	10.169
36	602393.139	314426.387	14.751
37	602404.415	314416.877	3.443
38	602405.838	314413.742	5.437
39	602408.086	314408.792	7.828
40	602411.531	314401.763	2.746
41	602412.585	314399.227	13.235
42	602418.579	314387.427	29.466
43	602438.037	314365.299	7.362
44	602442.445	314359.403	1.135
45	602443.210	314358.565	17.385
46	602454.179	314345.077	13.964
47	602462.990	314334.244	9.269
48	602468.839	314327.053	9.806
49	602475.026	314319.445	0.429
50	602475.297	314319.112	18.005
51	602485.025	314303.961	14.863
52	602493.000	314291.419	9.834
53	602497.496	314282.673	8.018
54	602501.124	314275.523	3.442
55	602502.668	314272.447	8.566
56	602506.513	314264.792	36.369
57	602520.311	314231.142	0.985
58	602520.559	314230.189	9.031
59	602522.828	314221.448	3.128
60	602523.614	314218.420	5.651
61	602524.229	314212.803	11.642
62	602525.496	314201.230	3.761
63	602525.906	314197.491	8.150
64	602526.144	314189.344	11.253
65	602526.472	314178.096	1.294
66	602526.434	314176.803	15.411
67	602525.987	314161.398	8.650
68	602527.579	314152.896	1.213
69	602528.019	314151.766	14.204
70	602533.189	314138.536	3.498
71	602529.976	314137.153	5.649
72	602531.929	314131.852	3.377
73	602535.099	314133.016	4.430
74	602536.691	314128.882	10.295
75	602539.125	314118.879	10.353
76	602541.573	314108.820	9.803
77	602545.918	314100.033	3.892
78	602547.445	314096.453	6.165
79	602550.263	314090.970	9.793
80	602554.618	314082.199	18.417
81	602562.812	314065.705	13.980
82	602569.093	314053.215	13.297
83	602574.144	314040.915	15.066
84	602580.804	314027.401	14.125
85	602587.197	314014.806	15.435
86	602594.070	314000.986	17.524
87	602605.127	313987.391	26.699
88	602583.127	314002.519	4.260
89	602582.030	314006.635	41.721
90	602564.043	314044.279	2.953
91	602562.256	314046.630	27.839
92	602550.019	314071.635	14.532
93	602543.750	314084.745	0.220
94	602543.670	314084.950	1.067
95	602543.126	314085.868	3.454
96	602541.599	314088.966	11.152
97	602536.864	314099.063	9.678
98	602533.249	314108.041	39.219
99	602518.097	314144.215	10.740

S(1Dr)=3821mp P=1092.538m

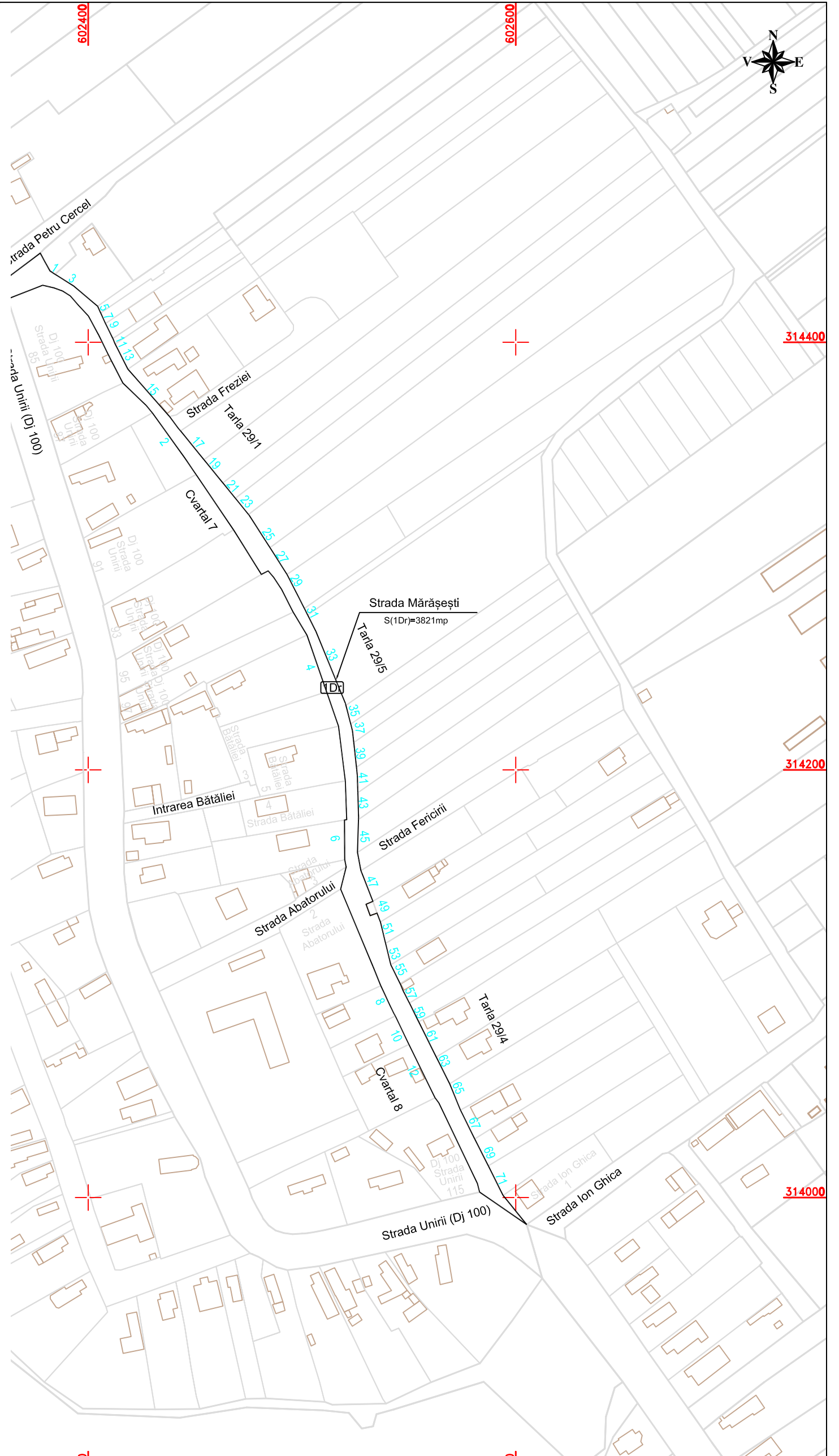

SISTEM DE PROIECTIE STEREOGRAFIC 1970

<b>SC KOMORA ENGINEERING SRL</b> J51/59/2014; CUI RO32815436 <small>Sediu: Aleea Centrala, nr. 1, etaj 1, camera 119-120, CĂLĂRAȘI</small>			BENEFICIAR: COMUNA FRUMUȘANI <small>Adresa: Comuna Frumușani, CĂLĂRAȘI.</small>		Faza
SPECIFICAȚIE	NUME	SEMNĂTURA	Scara 1:2000	PLAN DE SITUAȚIE STRADA MĂRĂȘEȘTI Număr cadastral 131 Sat Orăști, comuna Frumușani, județul Călărași	Planșa nr. 1
ÎNTOCMIT	Cristina MĂRĂNDESCU				
VERIFICAT	Ing. Dănuța Florica BAȘOTĂ		DATA 2018		