



INVENTAR DE COORDONATE-SISTEM DE PROIECTIE STEREOGRAFIC 1970

Parcela (1Dr) Strada Apelor

Nr. Pct.	Coordonate pct.de contur Y [m]	X [m]	Lungimi latituri D(L,I+1)
1	602133.636	314144.700	16.580
2	602134.630	314161.250	32.121
3	602136.250	314193.330	15.629
4	602128.990	314207.170	17.254
5	602117.890	314220.380	3.627
6	602118.680	314223.920	14.142
7	602121.770	314237.720	30.222
8	602128.380	314267.210	36.747
9	602129.800	314303.930	44.361
10	602125.546	314346.087	30.126
11	602122.657	314378.074	29.643
12	602112.042	314405.751	18.325
13	602105.762	314422.966	50.632
14	602084.539	314468.935	79.586
15	602048.587	314539.936	20.901
16	602039.818	314558.911	16.016
17	602034.480	314574.011	22.773
18	602033.843	314596.775	51.820
19	602031.865	314648.557	23.233
20	602029.503	314671.670	0.452
21	602029.457	314672.120	36.126
22	602026.553	314708.129	38.120
23	602029.930	314746.099	44.007
24	602032.460	314790.033	20.899
25	602030.811	314810.867	15.775
26	602026.248	314825.968	36.446
27	602009.082	314858.118	53.377
28	601978.266	314901.702	40.247
29	601952.414	314932.547	13.872
30	601942.881	314942.624	24.946
31	601920.894	314954.409	49.291
32	601876.824	314976.488	13.836
33	601863.316	314979.485	15.598
34	601847.749	314978.506	4.043
35	601846.911	314982.461	16.752
36	601863.630	314983.513	14.897
37	601878.173	314990.286	49.842
38	601922.735	314957.818	25.650
39	601945.342	314945.843	14.638
40	601955.402	314935.209	40.533
41	601981.439	314904.145	53.791
42	602012.493	314860.223	37.092
43	602029.963	314827.503	16.601
44	602034.765	314811.612	21.603
45	602036.469	314790.076	44.342
46	602033.920	314745.807	37.844
47	602030.567	314708.112	35.743
48	602033.441	314672.485	23.771
49	602035.857	314646.837	51.968
50	602037.841	314596.907	22.165
51	602038.461	314574.751	15.200
52	602043.527	314560.420	20.644
53	602052.188	314541.681	79.587
54	602088.140	314470.677	50.870
55	602109.463	314424.492	18.457
56	602115.789	314407.153	30.153
57	602126.586	314378.999	30.663
58	602129.527	314348.477	44.636
59	602133.808	314304.047	37.384
60	602132.363	314268.691	30.587
61	602125.852	314256.818	14.140
62	602122.587	314223.046	1.649
63	602122.226	314221.437	15.707
64	602132.331	314209.412	17.155
65	602140.300	314194.220	33.233
66	602138.624	314161.029	16.906
67	602137.610	314144.153	40.205
68	602141.538	314104.140	42.881
69	602144.686	314061.375	19.133
70	602152.870	314044.081	35.548
71	602167.716	314011.782	39.880
72	602180.822	313974.048	19.622
73	602187.862	313956.910	22.320
74	602190.411	313932.982	15.645
75	602198.281	313919.461	34.693
76	602225.352	313897.764	38.096
77	602253.682	313872.294	32.368
78	602278.612	313851.650	54.984
79	602323.971	313820.573	28.543
80	602348.796	313806.487	38.376
81	602384.941	313793.592	57.911
82	602440.746	313778.118	60.802
83	602500.472	313766.731	51.937
84	602530.518	313752.844	25.866
85	602575.835	313747.545	22.710
86	602598.475	313745.759	12.384
87	602610.391	313742.387	12.393
88	602620.519	313735.245	17.265
89	602632.634	313722.945	11.503
90	602642.112	313716.427	38.262
91	602673.639	313694.747	2.699
92	602675.863	313693.217	4.055
93	602674.143	313689.545	53.510
94	602630.052	313719.865	17.288
95	602617.921	313732.182	11.352
96	602608.644	313738.724	11.304
97	602597.767	313741.803	22.571
98	602575.266	313743.577	26.250
99	602549.573	313748.955	51.902
100	602499.561	313762.832	60.801
101	602439.836	313774.220	58.220
102	602383.733	313789.776	38.869
103	602347.124	313802.837	29.059
104	602321.850	313817.177	55.336
105	602276.201	313846.453	32.631
106	602251.068	313869.265	38.064
107	602222.762	313894.714	35.325
108	602195.198	313918.808	17.233
109	602186.530	313931.700	23.277
110	602183.946	313954.833	19.182
111	602176.869	313972.662	39.775
112	602163.996	314010.296	35.322
113	602149.245	314042.390	19.856
114	602140.752	314060.338	43.578
115	602137.552	314103.798	41.089

S(1Dr)=6957mp P=3487.496m

Parcela (2Dr) Strada Apelor

Nr. Pct.	Coordonate pct.de contur Y [m]	X [m]	Lungimi latituri D(L,I+1)
116	602981.687	313712.911	5.868
117	602975.802	313713.303	16.432
118	602959.393	313714.178	0.077
119	602959.331	313714.132	17.339
120	602942.018	313715.077	4.889
121	602937.137	313715.385	19.177
122	602917.886	313716.368	1.112
123	602916.876	313716.426	3.469
124	602913.412	313716.806	29.532
125	602883.920	313716.151	12.290
126	602871.666	313717.212	36.181
127	602832.609	313714.100	33.963
128	602798.648	313713.778	63.276
129	602735.536	313709.220	29.135
130	602710.058	313695.087	27.997
131	602688.951	313678.683	6.756
132	602683.142	313680.143	24.694
133	602682.070	313703.167	13.032
134	602704.476	313699.178	18.962
135	602717.712	313709.625	18.746
136	602735.985	313713.897	89.603
137	602825.321	313720.542	43.782
138	602889.046	313722.972	54.607
139	602923.604	313726.649	62.572
140	602986.033	313716.418	5.585

S(2Dr)=1805mp P=640.018m

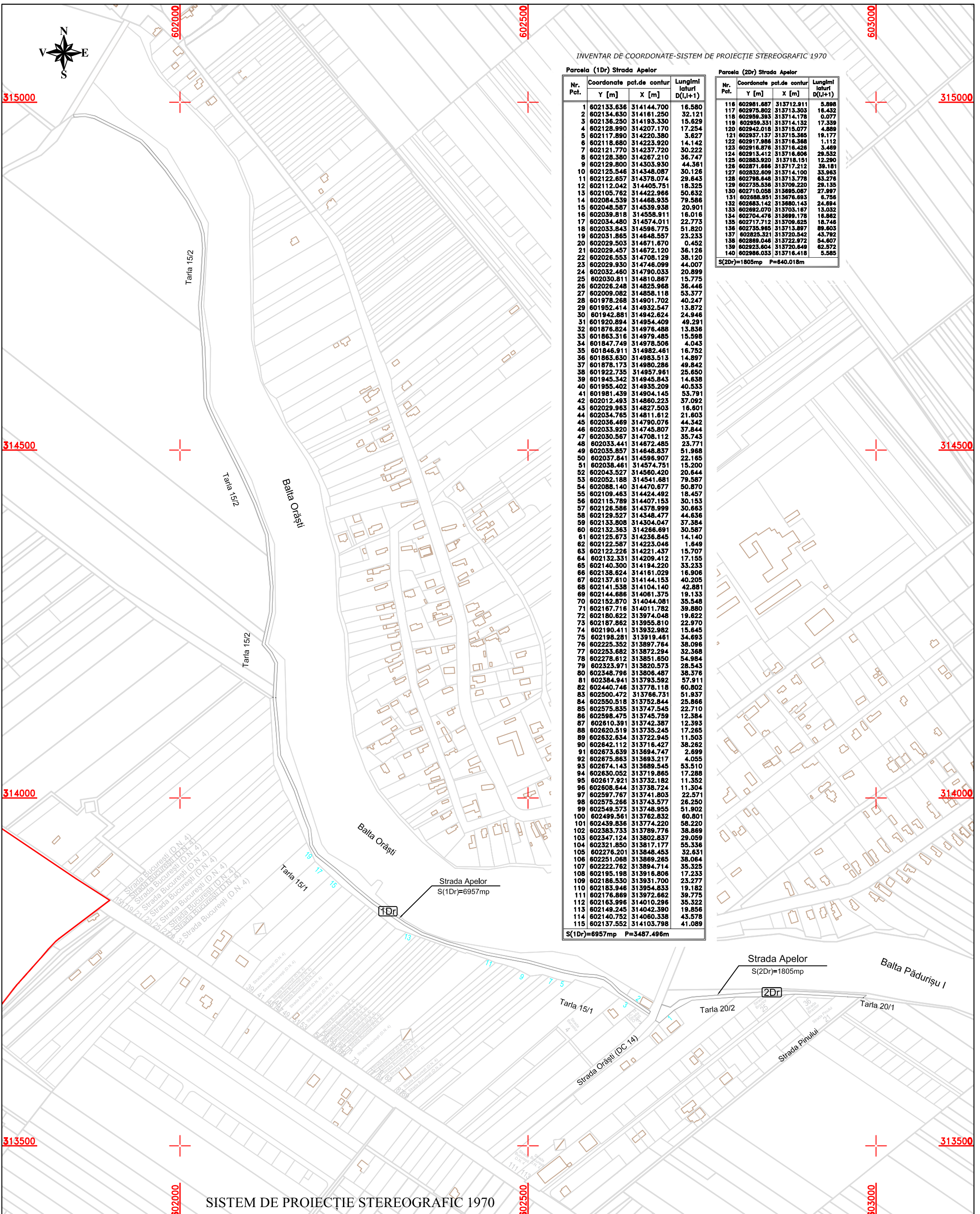

SISTEM DE PROIECTIE STEREOGRAFIC 1970

SC KOMORA ENGINEERING SRL  
J51/59/2014; CUI RO32815436  
Sediul: Aleea Centralei, nr. 1, etaj 1, camera 119-120, CĂLĂRAȘI



BENEFICIAR: COMUNA FRUMUȘANI  
Adresa: Comuna Frumușani, CĂLĂRAȘI

Faza

SPECIFICAȚIE	NUME	SEMNĂTURA
ÎNTOCMIT	Cristina MĂRĂNDESCU	
VERIFICAT	Ing. Dănuța Florica BAȘOTĂ	

Scara  
1:5000  
DATA  
2018

PLAN DE SITUAȚIE  
STRADA APELOR  
Număr cadastral 8959, 175  
Sat: Postăvari, Orășți; comuna Frumușani;  
județul Călărași

Planșa nr.  
1